

Valley of Our Lady Monastery

7320 Urness Road
Hollandale, WI 53544

The driveway entrance is at the crest of a hill on Urness Road. We recommend pausing once you pull in to enjoy the long view of the Blue Mounds from here. The driveway forks - take the far left drive and follow it until you get to the monastery. The driveway has bumpouts you can pull into if you meet on-coming traffic.



Stay straight on the drive way and park in the guest lot. Enter the Oratory by the courtyard and use the door straight ahead. There are restrooms on either side of the lobby. Follow the hallway to your left to get to the priest Vestry and Guest Nave.



Guest Seating

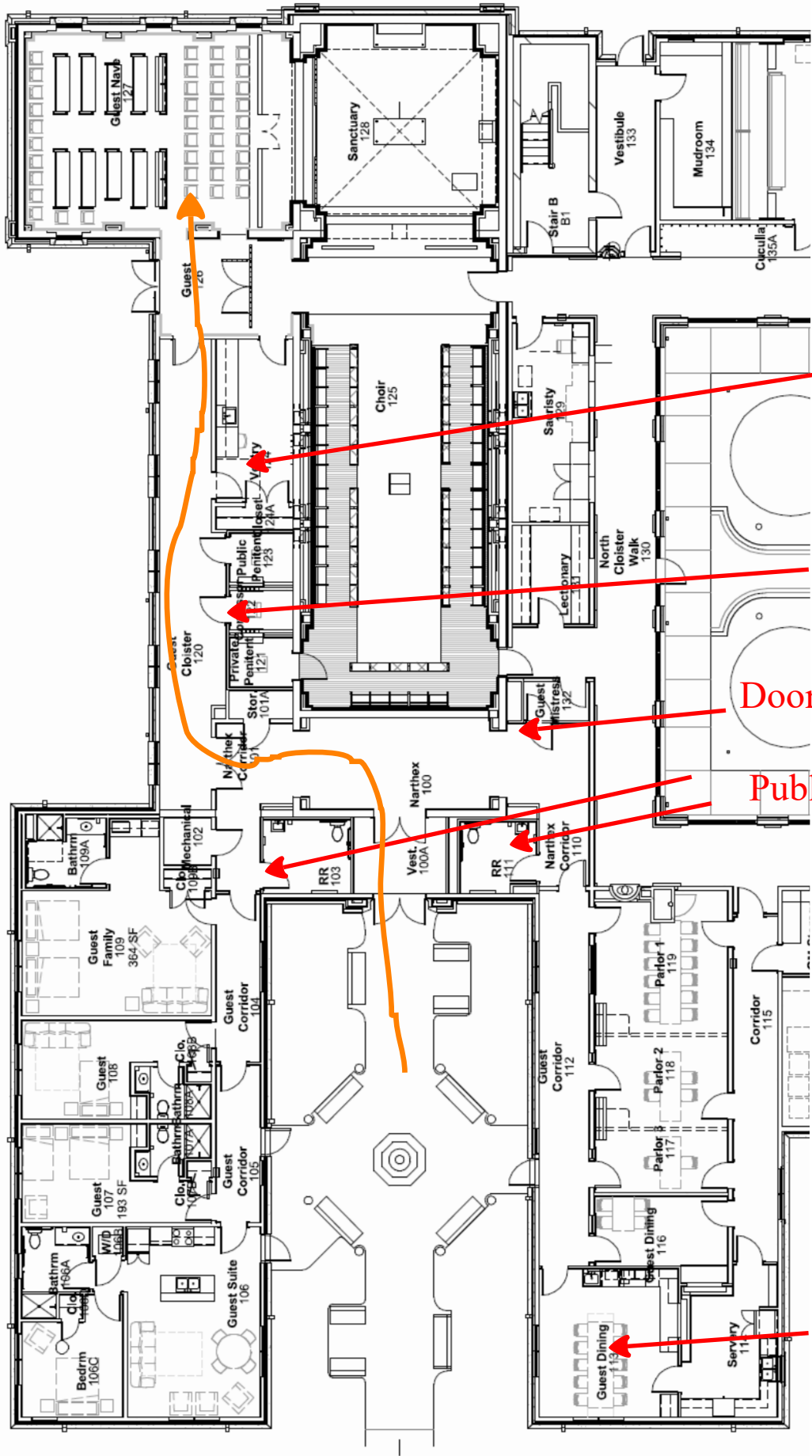

Vestry

Confessional priest door

Doorbell for assistance

Public Restrooms

Guest Dining